

## Fire Rating 1 Hour - Fiberock (SSF-25)

### Description

Frame : JayaBMS Wall Track, JayaBMS C Stud

Lining : 1 layer of USG Fiberock Aqua-Tough 12.7mm (both sides)

Weight :  $\pm 30 \text{ kg/m}^2$

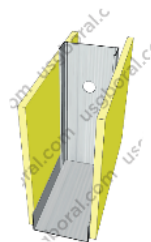

STUD SIZE (mm)		MAXIMUM HEIGHT (mm) Non-Load Bearing Studs			WALL THICKNESS (mm)	FIRE RATING (minutes)	ACOUSTIC RATING (STC)	
Width	Thickness	@600mm centres	@400mm centres	Grade BS 5234			Without Insulation	Insulation Mineral Wool 50mm
64	0.5	3400	3600	Severe Duty	89.4	60	36	48
	0.7	3600	3850			60		
76	0.5	3900	4200		101.4	60	38	49
	0.7	4150	4550			60		
92	0.5	4650	5100		117.4	60	40	50
	0.7	5000	5600			60		
100	0.5	5050	5600		125.4	60	40	50
	0.7	5500	6100			60		
150	0.7	7200	8050		175.4	60	42	51